

1 987 432 120

Nissan Micra (K12E) 11.02 →

Renault Clio III 06.05 →  
Renault Modus 06.04 →

- D** Innenraumfilter  
Montageanleitung
- GB** Cabin filter  
Installation instructions
- F** Filtre d'habitacle  
Notice de montage
- I** Filtro abitacolo  
Istruzioni di montaggio
- NL** Interieurfilter  
Montagehandleiding
- E** Filtro ventilacion para interior  
Instrucciones de montaje
- P** Filtro de purificação do habitáculo  
Instruções de montagem
- S** Kupéfilter  
Installationsanvisning

**BOSCH**

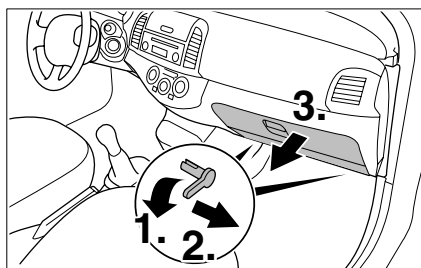
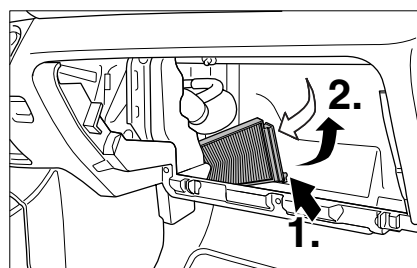
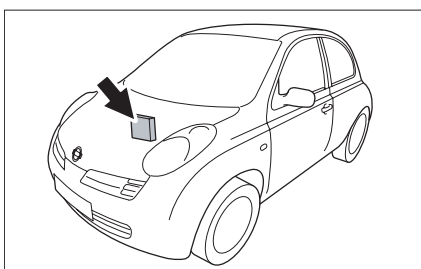
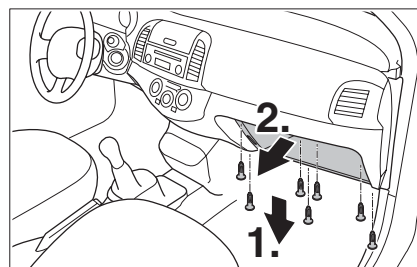
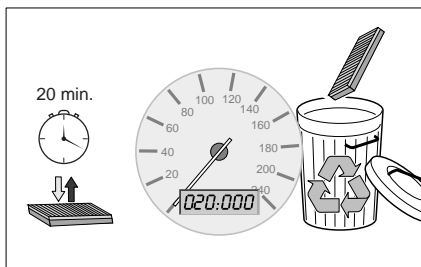

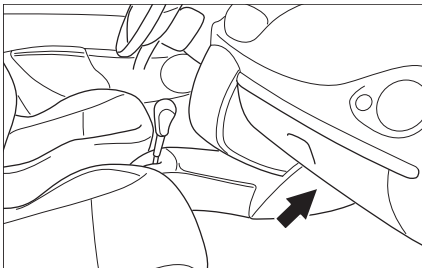
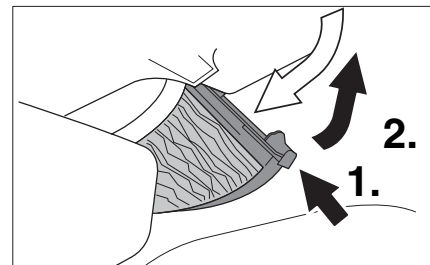
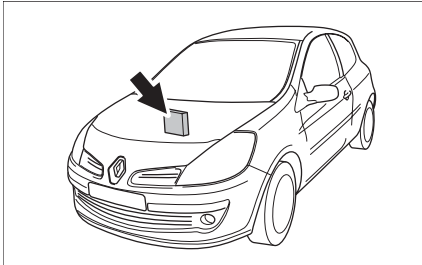
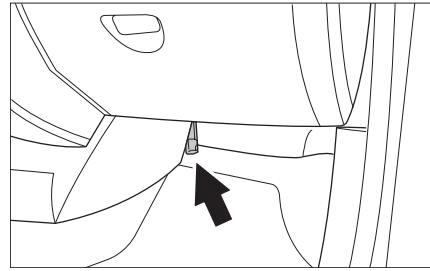
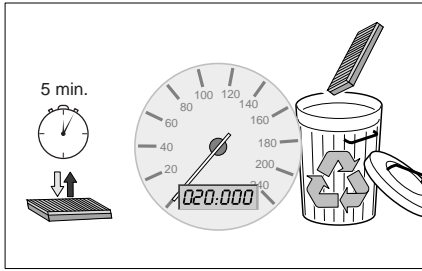

4 Renault Clio III

Renault Clio III 5

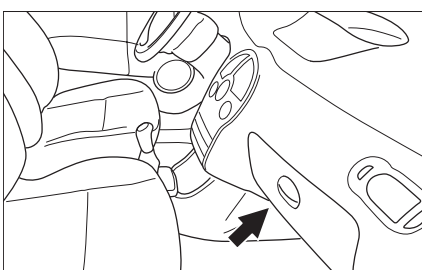
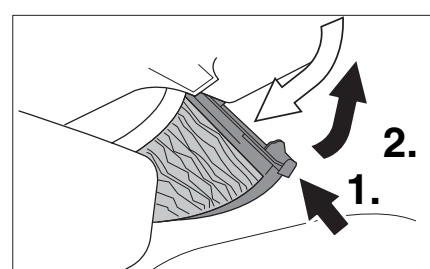
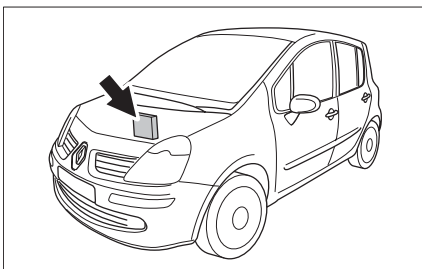
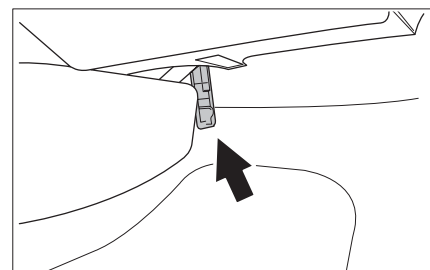
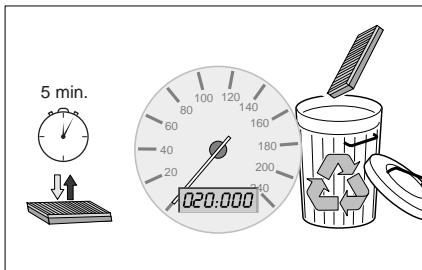

6 Renault Modus

Renault Modus 7



**Service**

**+49 (0) 180-500 4745**

gebührenpflichtig/subject to charges/payant



Robert Bosch GmbH  
Postfach 41 09 60, D-76225 Karlsruhe  
[www.bosch-automotive.com](http://www.bosch-automotive.com)



Gedruckt auf Recycling-Papier Printed in Germany  
Printed on recycled paper Imprimé en Allemagne