

- D** Innenraumfilter  
Montageanleitung
- NL** Interieurfilter  
Montagehandleiding
- GB** Cabin filter  
Installation instructions
- E** Filtro ventilacion para interior  
Instrucciones de montaje
- F** Filtre d'habitacle  
Notice de montage
- P** Filtro de purificação do habitáculo  
Instruções de montagem
- I** Filtro abitacolo  
Istruzioni di montaggio
- S** Kupéfilter  
Installationsanvisning

**BOSCH**

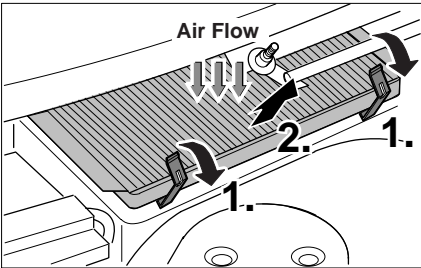

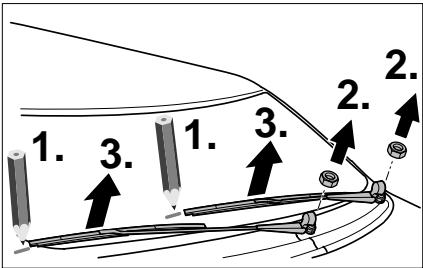
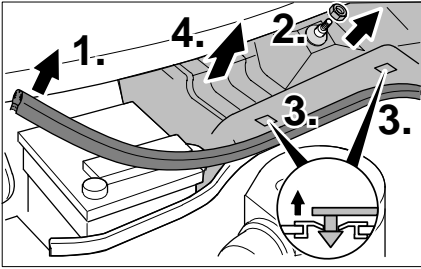
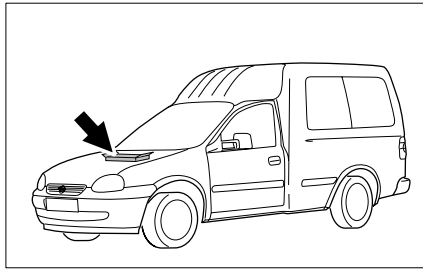
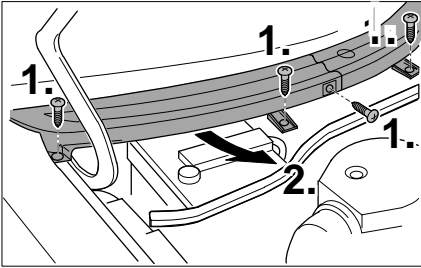
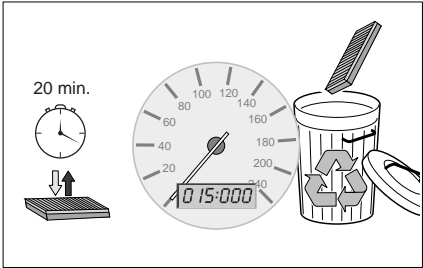
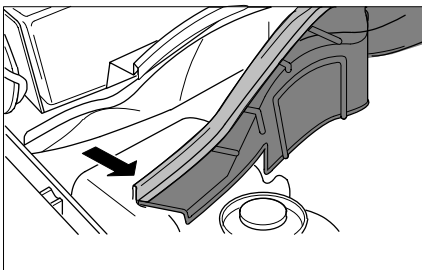
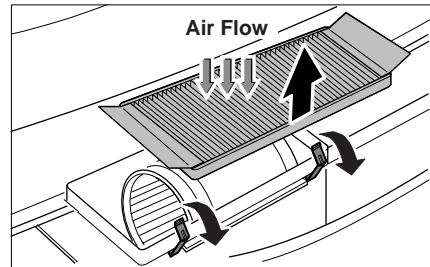
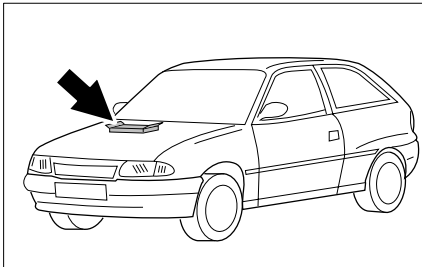
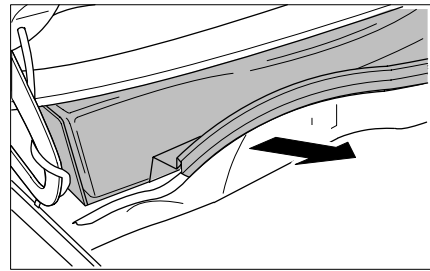
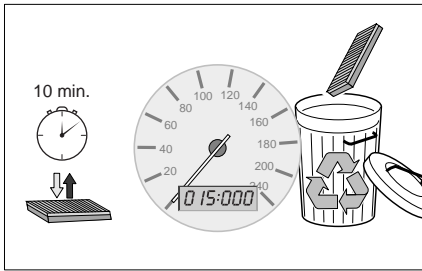

4

Opel Astra

Opel Astra

5

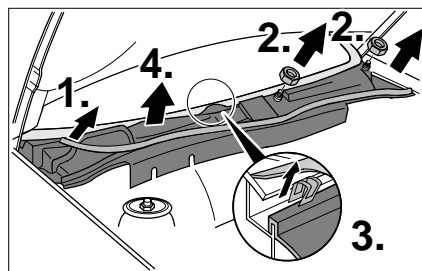
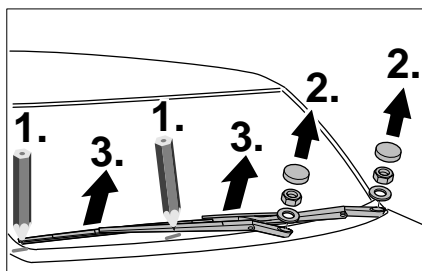
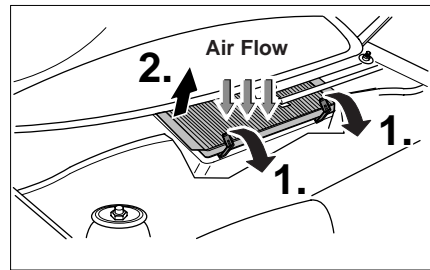
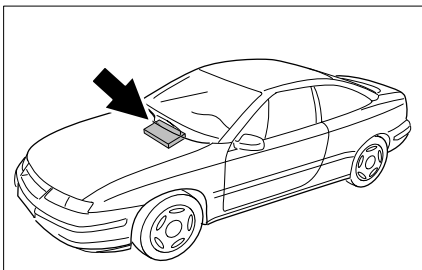

6

Opel Calibra

Opel Calibra

7

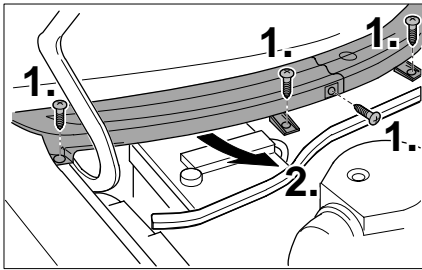
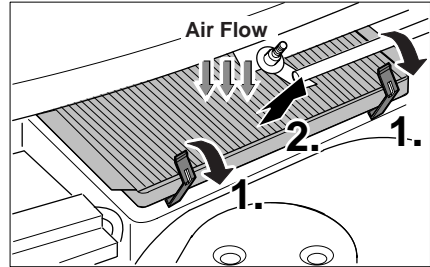
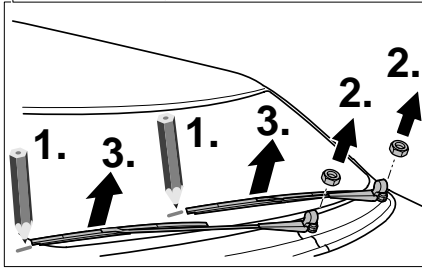
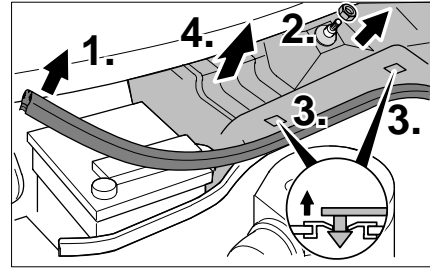
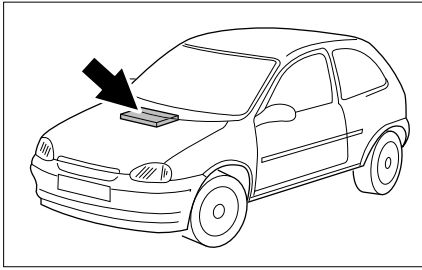

8

Opel Corsa

Opel Corsa

9

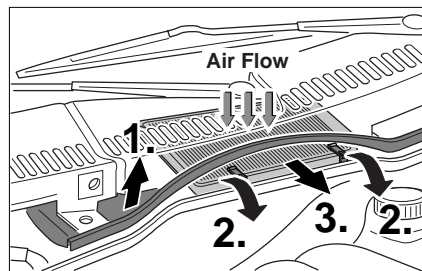
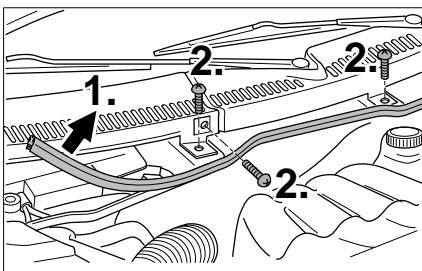
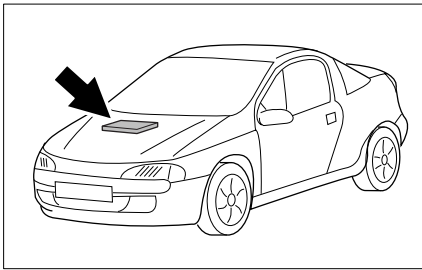

10

Opel Tigra

11



**Service**

**+49 (0) 180-500 4745**

gebührenpflichtig/subject to charges/payant



Robert Bosch GmbH  
Postfach 41 09 60, D-76225 Karlsruhe  
[www.bosch-automotive.com](http://www.bosch-automotive.com)



Gedruckt auf Recycling-Papier    Printed in Germany  
Printed on recycled paper        Imprimé en Allemagne